

FIRE·LITE® Alarms by Honeywell

ANN-80 & ANN-80-W Remote Fire Annunciator Installation Instructions

The ANN-80 & ANN-80-W Remote Fire Annunciators are compact, backlit LCD annunciators designed for use with compatible FACP's Fire Alarm Control Panels. The annunciators mimic the FACP display and are capable of displaying English-language text of system point status including device type, independent point alarm, trouble or supervisory zone and custom alpha labels programmed into the FACP. Refer to the FACP manual installation section for detailed system information and wiring.

Note: Installation and wiring must be done in accordance with NFPA 72 and local ordinances.

Specifications

TB1 Terminals 1 & 2

Operating Voltage Range: 18 VDC to 28 VDC
Current Consumption @ 24 VDC nominal (filtered and nonresettable):

- Normal/Standby (no activity): 37.0 mA
- Trouble Condition: 39.0 mA
- Alarm: 40.0 mA
- AC Fail (not backlit): 15.0 mA

TB1 Terminals 3 & 4

ANN-BUS rated at 5.5 VDC and 60 mA max.

Dimensions

6 7/8" W x 5 3/8" H x 1 3/8" D

Mounting

The ANN-80 (red) and ANN-80-W (white) have plastic enclosures that can be surface or semi-flush mounted in a single, double or 4" square electrical box.

To mount the ANN-80 Series enclosure:

1. Open the ANN-80 Series cover by turning the key switch counterclockwise to the ON (Unlocked) position.
2. Push in the snap latch tab located on the right side while pulling the cover open.
3. Pull wire through 7/8" hole in backplate and feed through wire channel to lower left corner of backplate before routing to terminal block (refer to appropriate FACP manual).

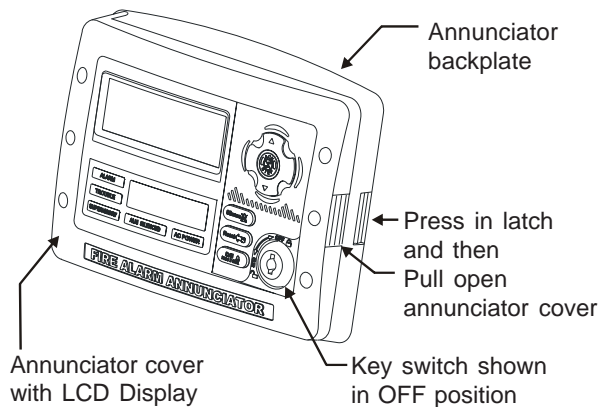

Figure 1: Opening ANN-80 Series

4. The cover must remain attached to the backplate while mounting the annunciator to the electrical box/wall. The cover cannot be reattached or removed after the annunciator has been mounted.
5. If the cover should become detached from the backplate, reattach as shown below.

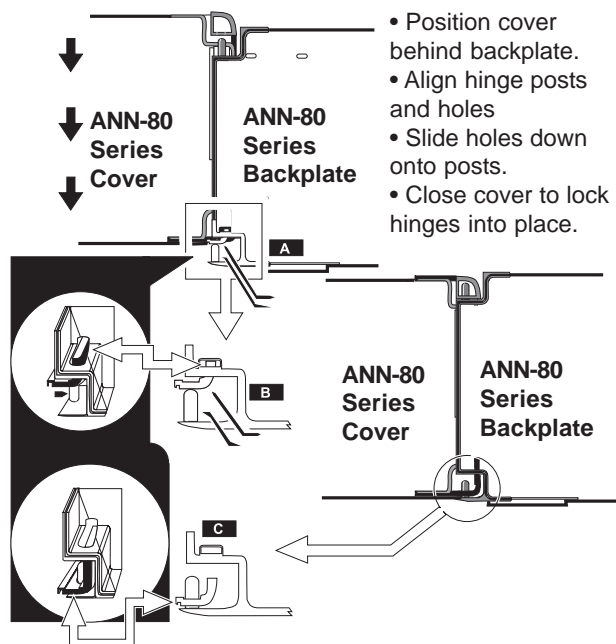

Figure 2: Cover Reattachment

6. Surface or Semi-flush mount annunciator to a single, double or 4" square electrical box.

Wiring ANN-80 Series to FACP

Refer to Table 1 and Figure 3 for wiring connections.

ANN-80 Series Terminals (TB1)	FACP ANN-BUS Terminals
Terminal 1 (-)	(-)
Terminal 2 (+)	(+)
Terminal 3 (A)	A (ANN-BUS)
Terminal 4 (B)	B (ANN-BUS)

Table 1: ANN-80 Series to FACP Connections

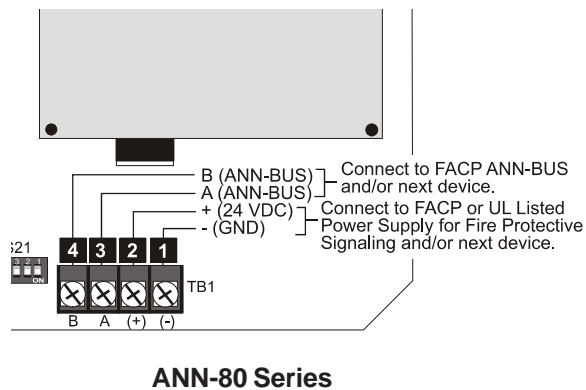

Figure 3: Wiring the ANN-80 Series to an FACP

Notes:

1. All connections/sources are to be power-limited and supervised.
2. 12 - 18 AWG (0.75 - 3.25 mm²) wire for 24 VDC circuit is acceptable.
3. Power wire distance limitation is set by 1.2 volt maximum line drop from source to end of circuit.
4. Maximum distance from FACP to last ANN-BUS device must not exceed 6,000 feet (1,800 m). Refer to Wiring Distance Table in appropriate FACP manual for wire gauge and distance limitations.

Setting DIP Switches

Each ANN-BUS device requires a unique address. ANN-80 Series DIP switch S21 is used to set the address for the annunciator. This address will be displayed on the annunciator LCD display as the Station ID number.

A maximum of 8 devices can be connected to the FACP ANN-BUS communication circuit. ANN-BUS device addresses do not need to be sequential and can be set to any number between 01 and 08. Note that 00 is not a valid address. The following illustrates the DIP switch settings for each address (ID Number):

ID Number (Address)	DIP Switch S21
(not valid) 00	
01	
02	
03	
04	
05	
06	
07	
08	