



www.firelite.com

July 8, 2004

DF-52086 • G-450

SpectrAlert®
Ceiling Mount Series
SC Strobes and PC Horn/Strobes
Section: Audio/Visual Devices

GENERAL

System Sensor's SpectrAlert® Ceiling Mount Series Strobes and Horn/Strobes offer a fresh approach to the unique needs of ceiling-mount applications.

Technology — Like the original SpectrAlert® line, the SpectrAlert® Ceiling Mount Series offers significant current draw reductions over other ceiling-mount strobes and horn/strobes.

Flexibility — SpectrAlert® Ceiling Mount strobes and horn/strobes are available in seven different candelas, including 177 candela for sleeping areas. The horn/strobe's tones are field-selectable with a three-position switch on the back of the unit. Selections include: electromechanical and 3 KHz tones; Temporal 3 and Non-Temporal 3 patterns; and high and low volume.

Aesthetics — SpectrAlert® Ceiling Mount strobes and horn/strobes offer a design that is sensitive to the aesthetic demands of ceiling-mount applications. The round shape maintains a low-profile appearance, similar to that of a smoke detector. Its stylish curves and design further refine the aesthetics over other generic wall/ceiling-mount designs. Yet SpectrAlert®'s round shape provides clearly visible "FIRE" identification from all angles.

Installation — SpectrAlert®'s compact design also offers installation savings. The strobe and horn/strobe models mount to a 4" x 4" x 1-1/2" (101.6 x 101.6 x 38.1 mm) backbox, and take up little room in the backbox, making connections easier. With SpectrAlert®'s round shape, aligning the backbox with the room's walls is not necessary — SpectrAlert® always lines up.

FEATURES

- Lower current draw.
- Available in 15, 15/75, 30, 75, 95, 115, and 177 candela strobes.
- Horn/strobe models include a three-position switch for field-selecting horn tones: electromechanical/3KHz; temporal 3/non-temporal 3; high/low dBA output.
- Synchronizable with MDL Sync•Circuit™ module.
- Ceiling-specific shape, profile, and aesthetics.
- Mounts to a 4" x 4" x 1-1/2" (101.6 x 101.6 x 38.1 mm) backbox.
- Round shape offers greater placement flexibility.

SPECIFICATIONS

Dimensions: 6.8" (172.72 mm) diameter.

Mounting: 4" x 4" x 1-1/2" (101.6 x 101.6 x 38.1 mm) backbox.

Indoor operating temperature: 32°F to 120°F (0°C to 49°C).

Maximum humidity: 95% as tested per UL 464.

Weight: 5.3 oz. (150 grams).



S4011
S5512



CS549



California
State Fire
Marshal
7135-1209:204
7125-1209:201



144-00-E
61-00-E



SC Strobe (top) and PC Horn/Strobe (bottom)

Operating voltage: 24 VDC and FWR unfiltered.

Input terminals: 12 to 18 AWG (3.25 to 0.75 mm²).

Operating voltage range: 24 volts, 16 – 33 volts. **NOTE:** 177 cd models tested at 20 – 33 V FWR and 16 – 33 VDC.

Operating voltage range with Sync•Circuit™ module: 24 volts, 17 – 33 volts. **NOTE:** 177 cd models tested at 21 – 33 V FWR and 17 – 33 VDC.

U.S. Patent Numbers: 6,049,446. 6,057,778. D424,465.

SpectrAlert® is a registered trademark and Sync•Circuit™ is a trademark of System Sensor.

Fire-Lite® Alarms is a Honeywell company.

This document is not intended to be used for installation purposes. We try to keep our product information up-to-date and accurate. We cannot cover all specific applications or anticipate all requirements. All specifications are subject to change without notice.

For more information, contact Fire-Lite Alarms, One Fire-Lite Place, Northford, Connecticut 06472. Phone: (800) 627-3473, Toll-Free FAX: (877) 699-4105.



SPECTRALERT CURRENT DRAW

	Model No.		Voltage	Candela	FWR Max. Operating Current - Strobe (mA RMS)	DC Max. Operating Current - Strobe (mA RMS)	FWR Max. Operating Current - Horn (mA RMS)	FWR Max. Operating Current - Horn (mA RMS)	Horn Audibility (dBA)
	Red	White							
Ceiling Mount Strobes	SC2415	SC2415W	15/75	15	68	64			
	SC241575	SC241575W	24	15/75	77	78			
	SC2430	SC2430W	24	30	107	113			
	SC2475	SC2475W	24	75	197	205			
	SC2495	SC2495W	24	95	239	274			
	SC24115	SC24115W	24	115	298	325			
	SC24177	SC24177W	24	177	399	489			
Ceiling-mount Horn/Strobes*	PC2415	PC2415W	24	15	68	64	57.5	57	75
	PC241575	PC241575W	24	15/75	77	78	57.5	57	75
	PC2430	PC2430W	24	30	107	113	57.5	57	75
	PC2475	PC2475W	24	75	197	205	57.5	57	75
	PC2495	PC2495W	24	95	239	274	57.5	57	75
	PC24115	PC24115W	24	115	298	325	57.5	57	75
	PC24177	PC24177W	24	177	399	489	57.5	57	75
Sync-Circuit	MDL	MDLW	Average Current (mA)		Peak Current (mA)		In-rush Current (mA)		
			DC	FWR	DC	FWR	DC	FWR	
			12	10	12	30	31	87	122
			24	11	15	35	37	198	262

General Notes:

1. All SC and PC strobes were only tested at the 16-33 Volt-FWR/DC Limits. This does not include the 80% low end and the 110% high end voltage limits. 2. Horn/Strobe current draws assume horn is set at Temporal 3, electromechanical tone, and high audibility.

Selectable Horn Tones		
Temporal	Low Volume	Electromechanical
		300 Hz Interrupted
	High Volume	Electromechanical
		300 Hz Interrupted
Non-Temporal	Low Volume	Electromechanical
		300 Hz Interrupted
	High Volume	Electromechanical
		300 Hz Interrupted

NOTE: For maximum brightness, unit must be mounted with flash angles as shown.

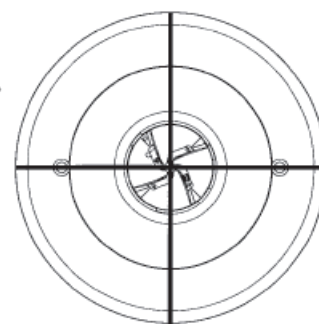

			UL Reverberant dBA @10 ft./volts DC			Anechoic dBA @10ft./volts DC		
			16	24	33	16	24	33
Temporal	Low Volume	Electromechanical	75	75	79	83	87	89
		3000 Hz Interrupted	75	75	79	82	86	89
	High Volume	Electromechanical	79	82	82	87	90	91
		3000 Hz Interrupted	79	82	82	86	92	93
Non-Temporal	Low Volume	Electromechanical	75	82	82	82	86	87
		3000 Hz Interrupted	79	82	85	84	87	90
	High Volume	Electromechanical	82	85	85	87	91	93
		3000 Hz Interrupted	82	85	85	88	91	92

SpectrAlert Dimensions

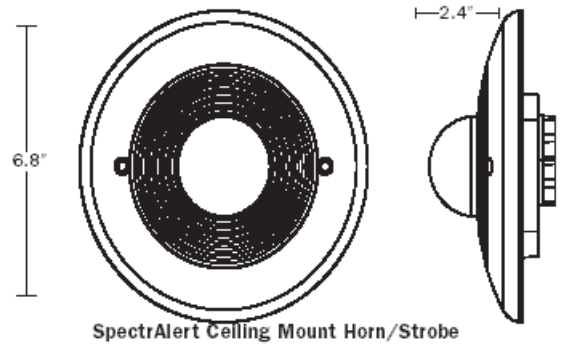
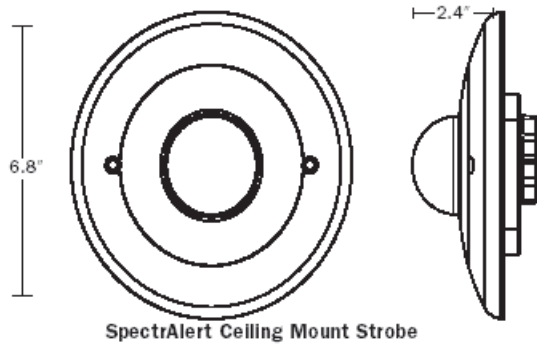

**Mounting
Strobe or
Horn/Strobe
with accessory
Backbox Skirt**

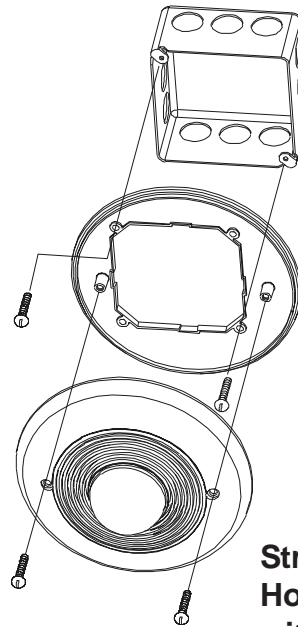
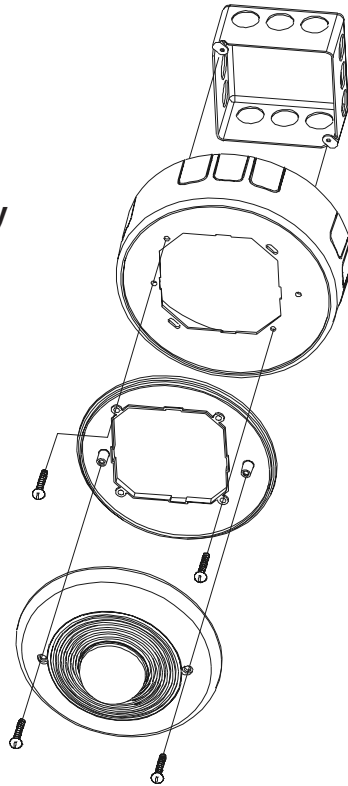

**Strobe or
Horn/Strobe
with Mounting
Plate**



BBSCW Surface-Mount Backbox Skirt

ARCHITECTURAL/ENGINEERING SPECIFICATIONS

Strobe shall be a System Sensor SpectrAlert® Model _____ Listed to UL 1971 and be approved for fire protective service where ceiling-mount strobes are permitted. The strobe shall be wired as a primary signaling notification appliance and shall flash at 1 Hz over the strobe's entire operating range. The strobe light shall consist of a xenon flash tube and associated lens/reflector system.

Horn/Strobe shall be a System Sensor SpectrAlert® Model _____ Listed to UL 1971 and UL 464 and be approved for fire protective service where ceiling-mount horn/strobes are permitted. The horn/strobe shall be wired as a primary signaling notification appliance and shall flash at 1 Hz over its entire operating range. The strobe light shall consist of a

xenon flash tube and associated lens/reflector system. The horn shall have two tone options, two audibility options, and the option to switch between a temporal 3 pattern and a non-temporal continuous pattern. These options shall be selected by a multi-position switch. Strobes shall be powered independently of the sounder with the removal of factory-installed jumper wires. The horn on horn/strobe models shall operate on a coded or non-coded power supply.

NOTE: *The strobes must be powered continuously for the horn to operate.*

Ordering Information	
Model Number	Description
SC2415	Ceiling-mount strobe, 24 volt, 15 candela, red
SC2415W	Ceiling-mount strobe, 24 volt, 15 candela, white
SC241575	Ceiling-mount strobe, 24 volt, 1575 candela, red
SC241575W	Ceiling-mount strobe, 24 volt, 1575 candela, white
SC2430	Ceiling-mount strobe, 24 volt, 30 candela, red
SC2430W	Ceiling-mount strobe, 24 volt, 30 candela, white
SC2475	Ceiling-mount strobe, 24 volt, 75 candela, red
SC2475W	Ceiling-mount strobe, 24 volt, 75 candela, white
SC2495	Ceiling-mount strobe, 24 volt, 95 candela, red
SC2495W	Ceiling-mount strobe, 24 volt, 95 candela, white
SC24115	Ceiling-mount strobe, 24 volt, 115 candela, red
SC24115W	Ceiling-mount strobe, 24 volt, 115 candela, white
SC24177	Ceiling-mount strobe, 24 volt, 177 candela, red
SC24177W	Ceiling-mount strobe, 24 volt, 177 candela, white
PC2415	Ceiling-mount horn/strobe, 24 volt, 15 candela, red
PC2415W	Ceiling-mount horn/strobe, 24 volt, 15 candela, white
PC241575	Ceiling-mount horn/strobe, 24 volt, 1575 candela, red
PC241575W	Ceiling-mount horn/strobe, 24 volt, 1575 candela, white
PC2430	Ceiling-mount horn/strobe, 24 volt, 30 candela, red
PC2430W	Ceiling-mount horn/strobe, 24 volt, 30 candela, white
PC2475	Ceiling-mount horn/strobe, 24 volt, 75 candela, red
PC2475W	Ceiling-mount horn/strobe, 24 volt, 75 candela, white
PC2495	Ceiling-mount horn/strobe, 24 volt, 95 candela, red
PC2495W	Ceiling-mount horn/strobe, 24 volt, 95 candela, white
PC24115	Ceiling-mount horn/strobe, 24 volt, 115 candela, red
PC24115W	Ceiling-mount horn/strobe, 24 volt, 115 candela, white
PC24177	Ceiling-mount horn/strobe, 24 volt, 177 candela, red
PC24177W	Ceiling-mount horn/strobe, 24 volt, 177 candela, white
Accessories	
MDL	Sync•Circuit™ module, red
MDLW	Sync•Circuit™ module, white
BBSC	Surface-mount back box skirt, red
BBSCW	Surface-mount back box skirt, white