

ECC-50DA(E) ECC-125DA(E) ECC-50BDA

DF-60763:C • C-210



Distributed Audio Amplifiers

Emergency Communications

General

The ECC-50DA(E), ECC-50BDA, and ECC-125DA(E) are intelligent 50 watt, 100 watt, and 125 watt amplifiers that are used with the ECC-50/100(E) Emergency Command Center. These distributed audio amplifiers amplify an audio message for distribution throughout a facility when additional audio power is required. They are designed as self-contained units and can be conveniently installed near an area of protection to reduce wiring demands for speaker circuit outputs.

Each ECC-50DA(E) is capable of producing 50 watts of total power and includes four built-in, fully supervised speaker circuits/zones. The ECC125DA(E) is capable of producing 125 watts of total power with four built-in, fully supervised speaker circuits/zones. Both amplifiers are expandable to include eight speaker circuits when an optional ECC-CE4 module is installed.

For installations that require survivability, the ECC-50BDA provides 50 watts or 100 watts of primary power along with 50 watts of backup power and comes standard with eight built-in, fully supervised speaker circuits/zones.

Any combination of up to eight, ECC-50DA(E)s, ECC-50BDAs, or ECC-125DA(E)s can be connected to the ECC-50/100(E) to provide a total output of 1100 watts of audio power and up to 24 speaker circuit outputs. These distributed audio amplifiers are wired to the data bus and the Audio-Riser bus of the ECC-50/100(E) primary operating console. They have their own power supplies with built-in battery charger and are both fully supervised by the ECC-50/100(E) for any trouble conditions.

Features

- The ECC-50DA(E) and ECC-125DA(E) units come standard with four onboard fully supervised speaker circuit zones, and are expandable to eight circuits when an optional ECC-CE4 module is added.
- The ECC-50BDA includes eight onboard fully supervised speaker circuits/zones.
- Any combination of up to eight ECC-50DA(E)s, ECC-50BDAs, or ECC-125DA(E)s per system can be used with the ECC-50/100(E) for a total of 1100 watts of audio power and 24 speaker circuit outputs.
- The ECC-50BDA can be used in the following configurations:
 - 50 Watts primary / 50 Watts back up
 - 100 watts primary / No back up
 - 100 watts primary / 50 Watts backup (Optional ECC-50WBU required)
- The ECC-50BDA supports the use of low frequency sounders per UL 464. Refer to the Device Compatibility Document #15384 for compatible devices.
- Supports both Class A (Style Z) and Class B (Style Y) wiring.
- Easy setup and configuration by using a simple, built-in web based programming utility on the ECC-50/100(E).
- UL2572 (Communication and Control Units Mass Notification Systems). UL 864 (Emergency Voice Evacuation for Fire).



- Built-in power supply and battery charger that supports up to 35AH. (For batteries larger than 18 AH, use the BB-26 or BB-55F Battery Box.)
- ECC-50DA(E) and ECC-50BDA are field selectable for 25Vrms or 70.7Vrms of operation.
- Sturdy, scratch resistant cabinet.

SOME SUITABLE APPLICATIONS

- Schools
- Healthcare Facilities
- Factories
- Theaters
- Military Facilities
- Restaurants
- Auditoriums
- Places of Worship
- Office Buildings
- Dormitories

Installation

The ECC-50DA(E), ECC-50BDA, and ECC-125DA(E) can be surface or flush mounted.

Compatibility

The ECC-50DA(E), ECC-50BDA, and ECC-125DA(E) are only compatible with the ECC-50/100(E) Emergency Command Center.

Electrical Specifications

PRIMARY AC POWER:

- **ECC-50DA:** 120VAC, 60Hz, 1200mA (max).
- **ECC-50DAE:** 240VAC, 50Hz, 600mA (max).
- **ECC-50BDA:** 120VAC, 60Hz, 2470mA (max).
- **ECC-125DA:** 120VAC, 60Hz, 2200mA (max).
- **ECC-125DAE:** 240VAC, 50Hz, 1250mA (max).

SPEAKER POWER:

- **ECC-50DA(E):** 50 watts primary only (25Vrms or 70.7Vrms).
- **ECC-50BDA:** 50 watts primary & 50 watts back up (25Vrms or 70.7Vrms); 100 watts primary only (25Vrms or 70.7Vrms); 100 watts primary & 50 watts back up (25Vrms or 70.7Vrms) (ECC-50WBU installed).
- **ECC-125DA(E):** 125 watts primary only (25Vrms).

SPEAKER OUTPUTS

- **ECC-50DA(E):** Four (4) supervised Class B (Style Y) or Class A (Style Z). outputs. (Expandable to eight with ECC-CE4).
- **ECC-50BDA:** (8) supervised Class B (Style Y) or Class A (Style Z). outputs.
- **ECC-125DA(E):** Four (4) supervised Class B (Style Y) or Class A (Style Z). outputs. (Expandable to eight with ECC-CE4).

SECONDARY POWER (BATTERY) CHARGING CIRCUIT

- Supports lead acid batteries only.
- Battery charge capability: 7AH to 35AH.

(The ECC-50DA(E), ECC-50BDA and the ECC-125DA(E) cabinet only support up to 18AH. For batteries larger than 18AH, use the BB-26 or the BB-55F battery box. A minimum of 35AH is allowed per system.

Other Accessories

BB-26: Battery cabinet used to mount up to two 26AH Batteries (BAT-12260).

BB-55F: Battery cabinet used to mount up to two 55AH Batteries (BAT-12250).

Product Line Information (Ordering Information)

ECC-50DA: Distributed (Remote) Audio Amplifier, 50 watts.

ECC-50BDA: Distributed (Remote) Audio Amplifier with back up, 50 watts/100 watts at 25Vrms or 70Vrms.

ECC-125DA: Distributed (Remote) Audio Amplifier.

ECC-50DAE: Export version, Distributed (Remote) Audio Amplifier, 50 watts, 240 VAC, 50 Hz.

ECC-125DAE: Export version, Distributed (Remote) Audio Amplifier, 125 watts, 240 VAC, 50 Hz.

ECC-50/100: (Primary operating Console) 50 Watt, 25VRMS single speaker zone emergency voice evacuation system, Integral microphone, built in tone generator and 14 recordable messages. *Please refer to the data sheet DF-60734 for more information.*

ECC-50/100E: Export version (Primary operating Console) 50 Watt, 25VRMS single speaker zone emergency voice evacuation system, Integral microphone, built in tone generator and 14 recordable messages. 240 VAC, 50 Hz. *Please refer to the data sheet DF-60734 for more information.*

ECC-CE6: Speaker Circuit/Zone Expander Module.

ECC-50W-25V: 25V, 50 watt audio amplifier module. Adding a second speaker circuit increases the total ECC-50/100 power output to 100 watts or can also be used as a backup amplifier.

ECC-50W-70V: 70V, 50 watt audio amplifier module. Adding a second speaker circuit increases the total ECC-50/100 power output to 100 watts or can also be used as a backup amplifier.

ECC-XRM-70V: 70V Transformer conversion module for 70V operation.

ECC-LOC: Local Operator Console (Complete user interface), *Please refer to the data sheet DF-60762 for more information.*

ECC-RPU: Remote Page Unit Hand held microphone, 14 message buttons. *Please refer to the data sheet DF-60761 for more information.*

ECC-RM: Remote Microphone only. *Please refer to the data sheet DF-60760 for more information.*

ECC-FFT: Fire Fighter Telephone System. *Please refer to the data sheet DF-60765 for more information.*

FPJ-F: Remote Phone Jack.

FHS-F: Fire Fighters Remote Handset.

FHSC-RF: Fire Fighters Handset Cabinet Recessed.

FHSC-SF: Fire Fighters Handset Cabinet Surface Mount.

MMF-301: Addressable Mini-Monitor Module.

I300: SLC Line Isolation Module.

TR-CE: Optional Trim Ring.

CHG-75: 25 to 75 ampere-hours (AH) external battery charger.

CHG-120F: 25-120 ampere-hours (AH) external battery charger.

ECC-MICROPHONE: Replacement microphone only.

ECC-THUMBLTCH: Optional Thumb Latch. (Non UL-Listed).

BAT-1270: Battery, 12volt, 7.0AH (Two required).

BAT-12120: Battery, 12volt, 12.0AH (Two required).

BAT-12180: Battery, 12volt, 18.0AH (Two required).

BAT-1260: Battery, 12volt, 26.0AH (Two required).

Optional Modules

ECC-CE4: Circuit Expander Module provides connections for up to four Style Z (Class A) or four Style Y (Class B) speaker circuits. Circuits are configured through the web-based programming utility on the ECC-50/100(E).

ECC-50WBU: Expander card for ECC-50BDA remote amplifier for 100 watt primary / 50 watt back up operation.

Wiring Requirements

See Product manual part number: LS10027-000FL-E for detailed wiring requirements.

Cabinet Specifications

16" W x 26.25" H x 4.125" D (40.64cm W x 66.68cm H x 10.48cm D).

Shipping Specifications

ECC-50DA Weight: 25.8 lbs (11.7kg)

ECC-50DA(E) Weight: 25.8 lbs (11.7kg)

ECC-125DA Weight: 24.3 lbs (11.02kg)

ECC-125DA(E) Weight: 24.3 lbs (11.02kg)

ECC-50BDA Weight: 28 lbs (12 kg)

ECC-50WBU Weight: 3 lbs (1 kg)

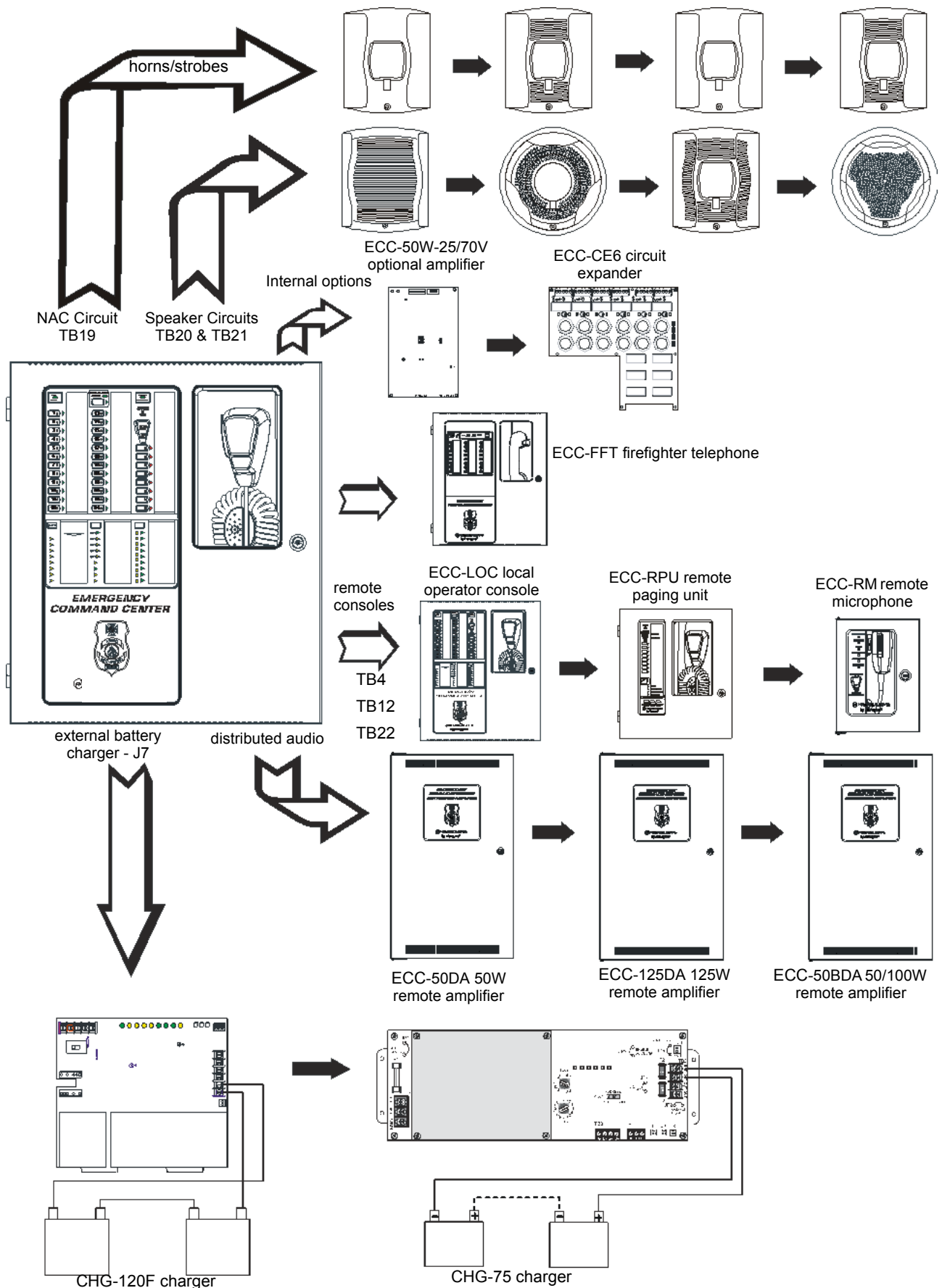

ECC-50/100(E) Emergency Command Center (Possible Configurations)

Temperature and Humidity ranges

This system meets NFPA requirements for operation at 0-49° C/32-120° F and at a relative humidity 93% ± 2% RH (non-condensing) at 32°C ± 2°C (90°F ± 3°F). However, the useful life of the system's standby batteries and the electronic components may be adversely affected by extreme temperature ranges and humidity. Therefore, it is recommended that this system and its peripherals be installed in an environment with a normal room temperature of 15-27° C/60-80° F.

Agency Listings and Approvals

The listings and approvals below apply to the ECC-50/125DA(E) Remote Amplifiers. In some cases, certain modules may not be listed by certain approval agencies or listing may be in process. Consult factory for latest listing status.

- UL Listed S2424
- CSFM: 7300-0075:0227
- FDNY: COA #6152

Standards and Codes

The ECC-50/100 system complies with the following UL Standards and with NFPA 72 Fire Alarm system requirements.

UL 864

UL 2572

Fire-Lite® Alarms is a registered trademark of Honeywell International Inc.
©2015 by Honeywell International Inc. All rights reserved. Unauthorized use
of this document is strictly prohibited.



This document is not intended to be used for installation purposes.
We try to keep our product information up-to-date and accurate.
We cannot cover all specific applications or anticipate all requirements.
All specifications are subject to change without notice.



Assembled in the USA

For more information, contact Fire•Lite Alarms. Phone: (800) 627-3473, FAX: (877) 699-4105.
www.firelite.com